



***XHD Lithium
Cordless Cut Out
Tool 18V -
Bare Tool***

TSC29



OPERATORS MANUAL



TABLE OF CONTENTS

Specifications	3
Product Identification	4
Safety Guidelines	5
Assembly	9
Operation	10
Maintenance	12

DISTRIBUTED BY:



Note

This manual is for your reference only. Due to the continuous improvement of the XHD Lithium products, changes may be made at any time without obligation or notice.

Thank You

For the purchase of this XHD Lithium product. We try our hardest to supply customers like you with the best quality products available, at the best price possible. We cant wait to continue working together in the future.



SPECIFICATIONS

Rated Voltage	18 V DC
Battery Type	Lithium-Ion
Speed (No Load)	25000 RPM
Working Depth	25mm
Net Weight	0.88kg
Sound Pressure Level: LpA	69.4 dB(A) K = 3 dB
Sound Power Level: LwA	80.4 dB(A) K = 3 dB
Vibration Level	1.721 m/s ² K = 7.5 m/s ²
Bit Size	Spiral 1/4" Shaft

PRODUCT IDENTIFICATION

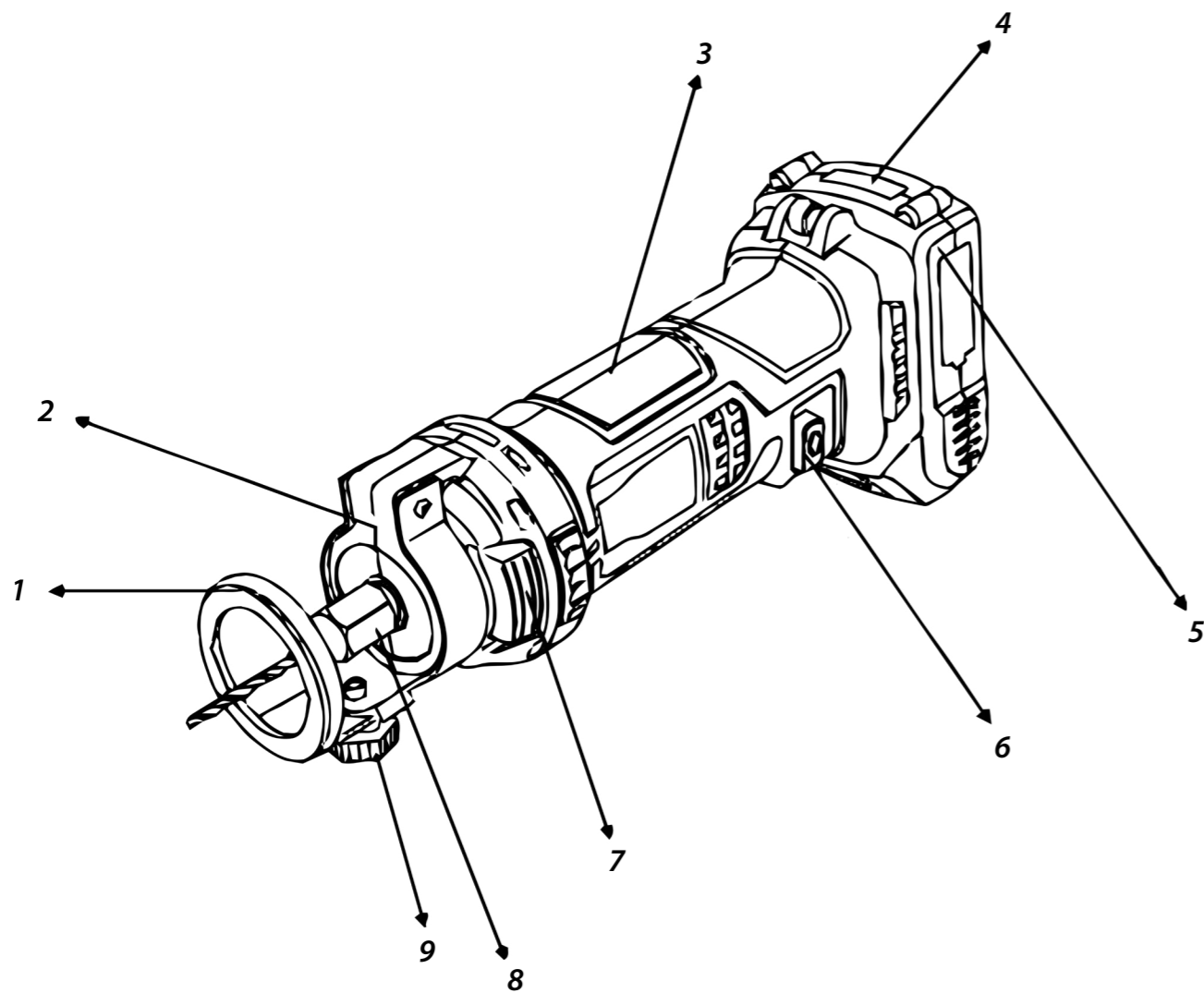

- 1 Depth Stop
- 2 LED Work Light
- 3 Soft Handle
- 4 Battery Indicator
- 5 XHD Battery (Not Included)
- 6 ON/OFF Power Switch
- 7 Spindle Lock Button
- 8 Tensioning Nut (With Collet)
- 9 Adjuster Screw for Depth Stop

SAFETY GUIDELINES

WARNING

READ ALL SAFETY WARNINGS & INSTRUCTIONS. Failure to follow instructions and warnings could lead to serious injury, electric shock, or fire.

Work Area Safety

- **Ensure that your work area is kept clean and well lit.** Lack of visibility and clutter greatly increase the risk of accident when using tools.
- **Keep bystanders, pets, and children clear when operating this power tool or machine.** They can cause distraction or risk injury to themselves.
- **Ensure you are not operating the power tool or machinery in the presence of dust, liquids, flammable gases, or anything that can create an explosive atmosphere.** Power tools and machinery can create sparks which can lead to ignition and fire hazards in working environments.

Personal Safety

- **Always wear personal protective equipment (PPE).** Eye protection, ear protection, dust masks, and other protective equipment will help to reduce the risk of personal injury or long-term illnesses.
- **Dress appropriately. DO NOT wear loose clothing that can get caught in moving parts.** Keep hair, loose clothing, jewellery, and anything else that could be of risk, away

from moving parts in the machine, or they could become caught therein.

- **Always remain alert and DO NOT operate power tools or machinery under the influence of any substances such as alcohol or drugs, including prescription medications.** Lack of focus could lead to injury or accidents while operating these power tools and machinery.
- **Always ensure proper footing and balance.** Overreaching can lead to slipping and falling which can result in injury or accident.
- **Ensure the power switch is in the OFF position before connecting any battery, or power source to the power tool or machinery.** This can cause injury as tools and machinery can suddenly fire incidentally when live, causing accidents.
- **Use all provided dust collection and extraction attachments, if included.** This equipment, along with the use of PPE dust masks, can help keep you safe from dust inhalation, and keep your work site clear from hazards.
- **Ensure loose parts such as wrenches or adjusting keys are removed before starting the power tool or machinery.**



SAFETY GUIDELINES

Power Tool & Machinery Use & Care

- **Use the correct tool for the job.** Forcing a tool to do a job it was not designed for increases the risk of accident or injury.
- **Disconnect tools and machinery from power, or remove batteries before doing any maintenance or adjustments, or before storing the tools and machinery.** This reduces or removes the risk of a power connection that causes the tool or machinery to accidentally fire, which can help prevent injury or accident.
- **Check the general condition of the power tool for damage or any problems that could affect the way the tool or machine works.** An unrepaired tool or machine can lead to accident and injury. Only have your tool or machine repaired with genuine parts from your local distributor
- **Only use the power tool and machinery with genuine parts or accessories that are designed to be used with this power tool and machinery.** Failure to do so could result in accident or injury, or damage your tool or machinery.
- **Store your tool or machinery out of reach of children, and away from untrained personnel when not in use.** Use by somebody untrained, or a child, could lead to accident or serious injury.

Service

- **Have your tools and machinery serviced by your local distributor with genuine XHD Lithium replacement parts.** This will ensure that the safety of the power tool or machine is maintained.



WARNING

The warnings and precautions discussed in this manual cannot cover all possible conditions and situations that may occur. It must be understood by the operator that common sense and caution are factors which cannot be built into this product, but must be supplied by the operator.

Always Use Common Sense

- It is not possible to cover every conceivable situation you can face. Always exercise care and use your common sense. If you get into a situation where you feel unsafe, stop and seek expert advice. Contact your dealer, service agent, or an experienced user. Do not attempt any task you feel unsure of!
- **Do not let familiarity gained from the frequent use of tools allow you to become complacent and ignore tool safety principles.** A careless action can cause severe injury within a fraction of a second.



SAFETY GUIDELINES

Battery Tool Use & Care

- Prevent unintentional starting. Ensure the switch is in the OFF position before connecting to the battery pack, picking up, or carrying the machine. Carrying the machine with your finger on the switch or energising a machine that has the switch ON invites accidents.
- Disconnect the battery pack from the machine before making any adjustments, changing accessories, or storing the machine. Such preventive safety measures reduce the risk of starting the machine accidentally.
- Recharge the battery only with the charger specified by the manufacturer. A charger that is suitable for one type of battery pack may create a risk of fire when used with another battery pack.
- Use machines only with specifically designated battery packs. Use of any other battery packs may create a risk of injury and fire.
- When the battery pack is not in use, keep it away from other metal objects, like paper clips, coins, keys, nails, screws, or small metal objects, that can make a connection from one terminal to another. Shorting the battery terminals together may cause burns or a fire.
- Under abusive conditions, liquid may be ejected from the battery; avoid contact. If contact accidentally occurs, flush the area with water. If liquid contacts eyes, seek medical help. Liquid ejected from the battery may be acidic and may cause irritation or burns.
- Do not use a battery pack or machine that is damaged or modified. Damaged or modi-

fied batteries may exhibit unpredictable behaviour resulting in fire, explosion, or risk of injury.

- Do not expose a battery pack or machine to fire or excessive temperature. Exposure to fire or temperature above 130°C may cause explosion.
- Follow all charging instructions and do not charge the battery pack or machine outside of the temperature range specified in the instructions.
- Charging the battery improperly, or at temperatures outside of the specified range may damage the battery and increase the risk of fire.
- Have servicing performed by a local XHD distributor repair person using only identical replacement parts. This will ensure that the safety of the product is maintained.
- Do not modify or attempt to repair the machine or the battery pack except as indicated in the instructions for use and care.

Battery Long Life Tips

- Charge the battery cartridge before it is completely discharged. Always stop tool operation and charge the battery cartridge when you notice less tool power.
- Never recharge a fully charged battery cartridge. Overcharging shortens the battery service life.
- Charge the battery cartridge with room temperature at 10°C – 40°C. Allow a hot battery cartridge to cool before charging it.
- Charge the battery cartridge once in every six months if you do not use it for extended periods at a time.

SAFETY GUIDELINES

Multi Cutter Specific Safety

- Only use accessories recommended by the manufacturer. The use of other accessories can result in a risk of personal injury.
- Only use the tool on dry surfaces. There is an increased risk of electric shock if water enters a power tool.
- Find out whether the surface in question will product toxic dust and/or fumes. Some woods contain preservatives that can be toxic. Take extra care to prevent inhalation and skin contact when working with these materials.
- Keep your hands away from the cutting area and the blade. If you always handle the tool with both hands, they cannot come into contact with the blade.
- Do not put your hands under the workpiece. Contact with the blade could cause personal injury.
- Start the tool before applying the blade to the workpiece. If the blade jams, it can slip or kick back from the workpiece when the tool starts.
- Never hold the workpiece in your hands or across your legs. Secure the workpiece on a stable surface. It is important to support the workpiece properly so that body contact is minimised, the blade does not jam, and you do not lose control.
- Make sure there are no nails, screws or other foreign objects in your workpieces.
- Do not use blunt or damaged blades. Blades with blunt or damaged teeth produce more friction, which can cause the blade to jam and increases the risk of kickback.
- Take extra care when plunge cutting in walls or other similar areas where you cannot see what lies behind. The protruding blade may strike objects that can cause kickback.
- The work area should be well ventilated.
- Wear PPE safety glasses.
- Wear PPE ear protection.
- Wear a PPE dust filter mask if the work produces a lot of dust.
- Wear PPE safety gloves.
- Tie your hair back if you have long hair.
- DO NOT wear loose-fitting clothes, jewellery, or watches etc. that can fasten in moving parts.
- If dust extraction and dust collection equipment is available, this should be connected and used correctly. Clean the ventilation openings regularly. The accumulation of metal dust can cause the metal parts of the tool to become live, this may cause a risk of electric shock.
- Avoid accidental starting. Switch off the tool if the power supply is disconnected, e.g. as a result of a power cut or if the power cord is pulled out.
- Secure the workpiece. Secure the workpiece with clamps or a vice. Never hold the workpiece with your hand.
- Hold the power tool by the insulated grips when working in areas where the tool may come into contact with concealed electrical cables or its own power cord. Contact with a live cable will cause the metal parts on the tool to also become "live" - risk of electric shock.

ASSEMBLY

WARNING

Always remove the battery before replacing the tool insert or the collet.

The bits have sharp edges. Handle with care.

Never tighten the tensioning nut without a bit in the collet. Always use the correct collet for the cutter insert.

Installing & Removing the Battery

- To remove the battery cartridge, slide it from the tool while sliding the button on the front of the cartridge.
- To install the battery cartridge, align the tongue on the battery cartridge with the groove in the housing and slip it into place. Insert it all the way until it locks in place with a little click. If you can see the red indicator on the upper side of the button, it is not locked completely.

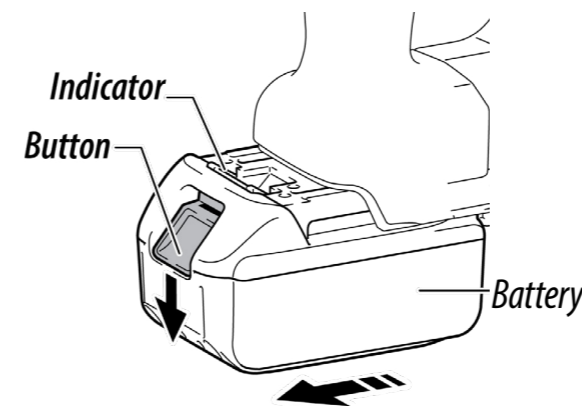

Indicating the Remaining Battery Capacity

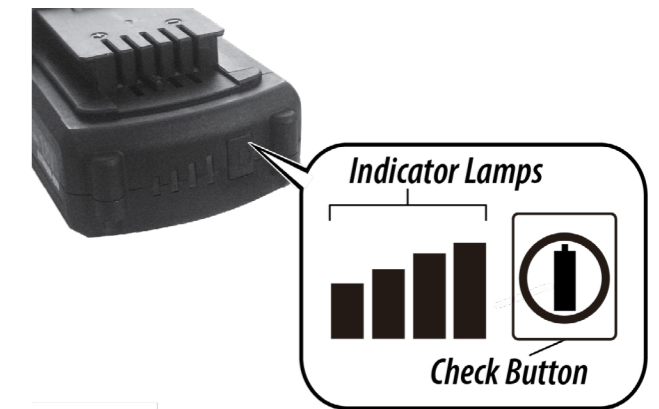

- Press the check button on the battery cartridge to indicate the remaining battery capacity. The indicator lamps light up for few seconds.

NOTE: Depending on the conditions of use and the ambient temperature, the indication may differ slightly from the actual capacity.

INDICATOR LAMPS			REMAINING CAPACITY
LIGHTED	OFF	BLINKING	
			75% to 100%
			50% to 75%
			25% to 50%
			0% to 25%
			Charge the Battery.
			The Battery may have Malfunctioned

OPERATION

Installing & Removing the Bits

Use 1/4" tool inserts for 1/4" collects.

1. Remove the battery, see; *Installing & Removing the Battery* page 9.
2. Press the spindle lock and unscrew the tensioning nut anticlockwise with the supplied spanner.
3. Put a suitable collet in the spindle (1/4" Shaft).
4. Insert the stem of the tool insert in the collet. Check that the collet only touches the stem and secure the tool insert.
5. Screw on the tensioning nut again.
6. Press the spindle lock and screw tight the tensioning nut clockwise with the supplied spanner.

Follow the instructions in the reverse order to remove or replace bits.

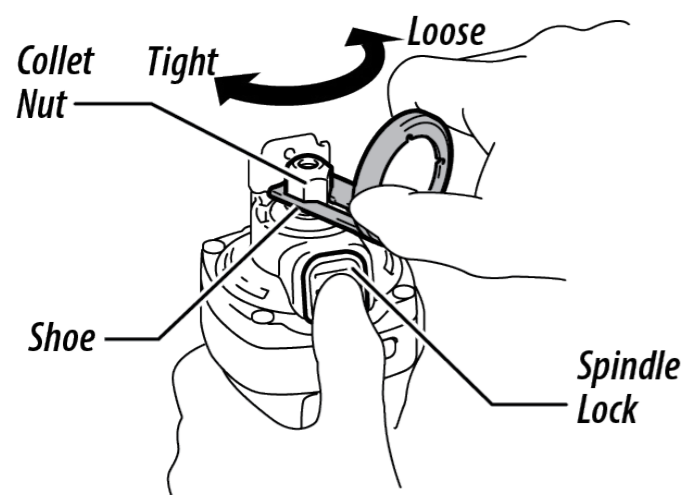

WARNING

To reduce the risk of accidents, always wear safety glasses.

Do not work on material that contains nails, screws or clips.

If the machine makes contact with foreign objects this can cause the machine to kick back and cause personal injury.

Adjusting the Depth Stop

Use the tool-free depth setting to adjust the depth stop before use.

1. Press in the adjuster button for the depth stop.
2. Move the stop in or out.
3. Release the adjuster button. Check that the depth stop is firmly locked before use.
4. For best results set the depth stop so that the cutter tip extrudes 1/8" over the workpiece.

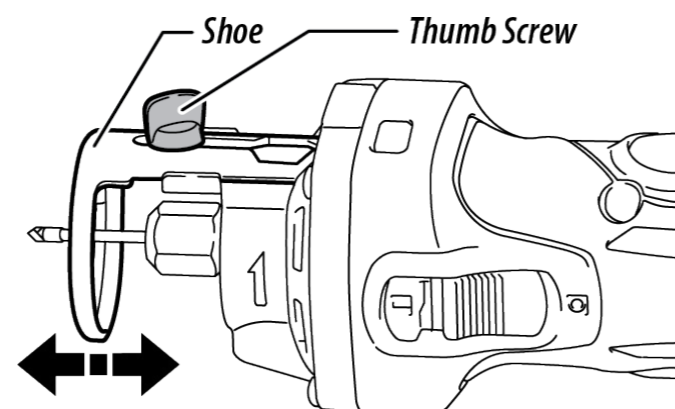

OPERATION



WARNING

Wait until the cutter tip has reached its run speed before it touches the workpiece. If the tip touches the workpiece on starting there is a risk of the machine bouncing.

Machining

- Start the machine by putting the power switch in the "I" position. The LED indicator goes on when the machine is started.

NOTE: Always check that there are no concealed cables in the work area before starting the work.

NOTE: Reduce the risk of explosion, electric shock, personal injury and material damage, by always switching off the power in all the circuits in the work area.

1. Set the depth stop so that the bit is positioned a few millimetres from the material.
 - Always use the depth stop to prevent the tool from going too deeply into the material. If the tool goes in too deeply there is a risk of making contact with electrical cables.
2. Start the machine and wait until it reaches its run speed
3. Hold the machine firmly with both hands when working.
4. Hold the depth stop flush with the workpiece and cut by moving the machine.
5. To cut a hole, drill a hole in the middle first before sawing out the edges. Cut counter-clockwise.

6. Switch off the machine after cutting. Wait until the bit has stopped before putting the machine to one side.

NOTE: Do not work with the material on a hard surface. The bit can make contact with the hard surface underneath.



WARNING

Check that the machine has stopped. Moving parts can grip surfaces and cause personal injury.



MAINTENANCE

- Before cleaning or performing any maintenance, you must ensure the tool is switched off and disconnected from the power supply.
- Compressed air is the most effective way to clean this tool. Always wear PPE safety goggles when cleaning tools with compressed air.
- Ventilation openings and switch levers must be kept clean. DO NOT attempt to clean by inserting pointed objects through openings.
- Do not use harsh chemicals or solvents when cleaning this tool.
- If you discover any damaged or broken parts, consult your local XHD distributor for replacements and advise.
- Store the machine in a dry, frost-free place.



WARNING

Always be sure that the tool is switched off and the battery removed before attempting to perform any inspection or maintenance.

Environment & Disposal

- Packaging materials are raw materials and can be re-used. Separate the different packaging materials and take them to the appropriate waste disposal facility. More information can be obtained from your local authorities.
- Old machines do not belong in your household garbage! Dispose of old machines appropriately, we are all responsible for the environment.